

Packing list

Frame	pcs
Pre-assembled frame set	
Outer pipe	2
Connection pipe	2
Control box	1
Gear motor	1
Aluminum extension set	1
Cable clamp	7
Set screw for con. pipe, M8 x 35 mm	8
Column	
Column	2
End pipe	2
Foot	2
Rubber washer	18
Accessory	
Control	1
AC cable	1
Hardware	
Screw for column, M6 x 16 mm	8
Screw for foot, M10 x 16 mm	8
Screw for control, Ø4 x 25 mm	2
Allen key for foot, 5 mm	1
Allen key for column, 4 mm	1
Screw for endpipe, Ø6 x 12 mm	8
Screw for Wood top 10# x 7/8	18
Make sure all screws are tightened.	

Reset the desk before use

Press both ▲▼ buttons at the same time for 3 seconds. Continue pressing the buttons until both columns are in lowest position. When finish reset, the control box makes a sound and the buttons can be released. Now the system is operational.

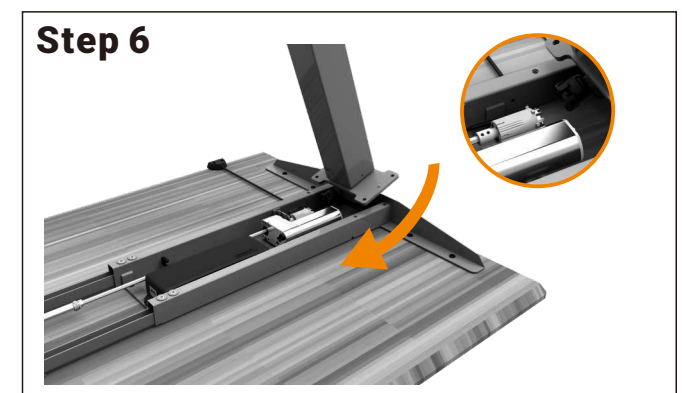
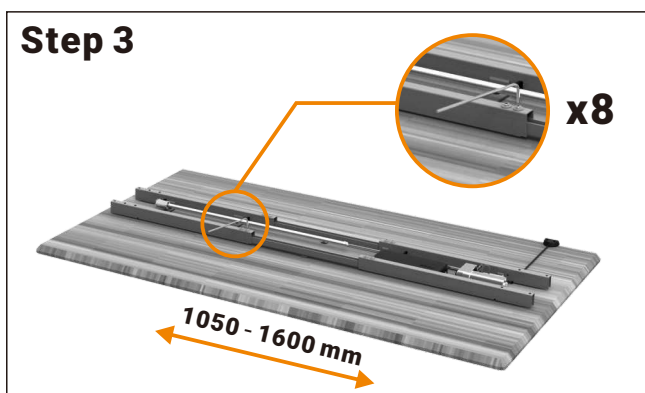
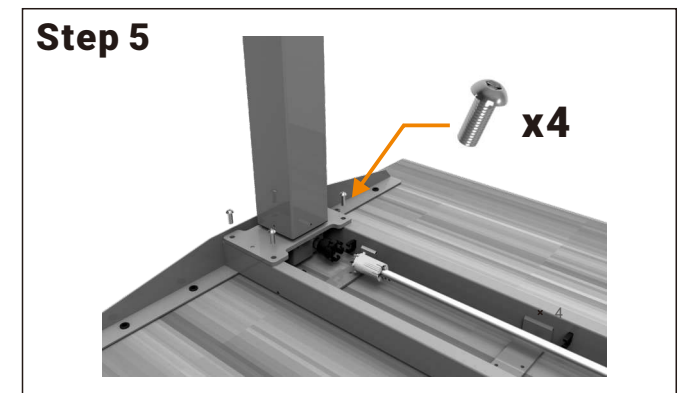
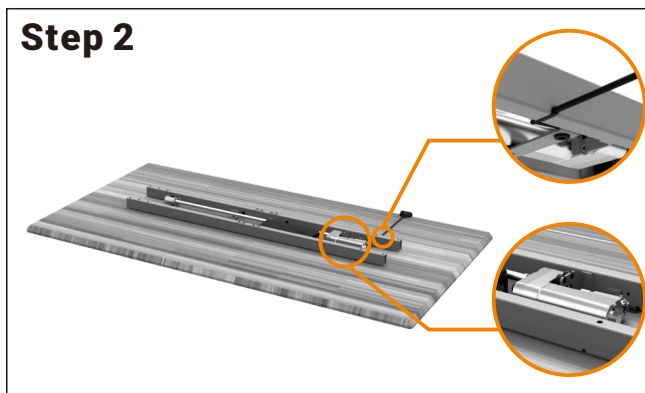
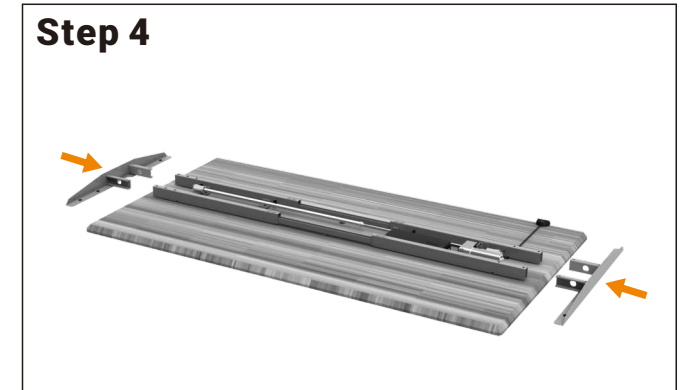
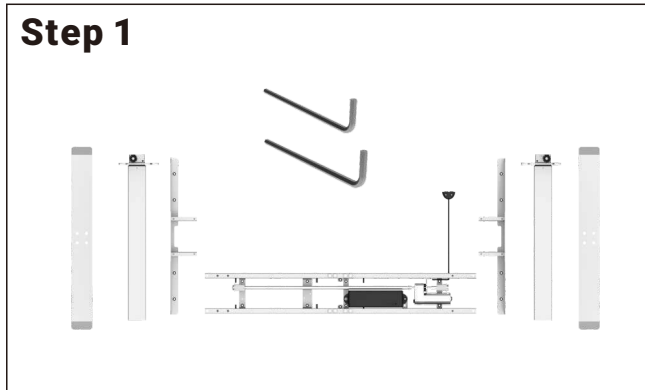

ASSEMBLY MANUAL

