

ASSEMBLY INSTRUCTION

PLTLEG - U - 24NB / 30NB

Bolts M6 x 16 mm

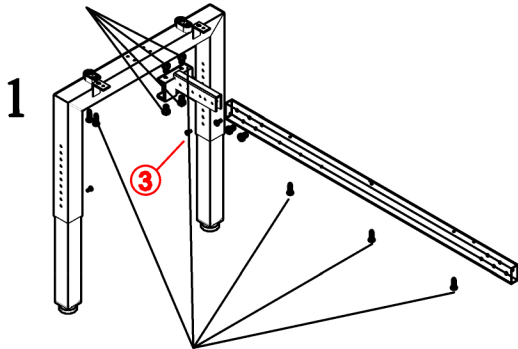

Wood Screw x 20 mm
(STEP 1 - 5)

2

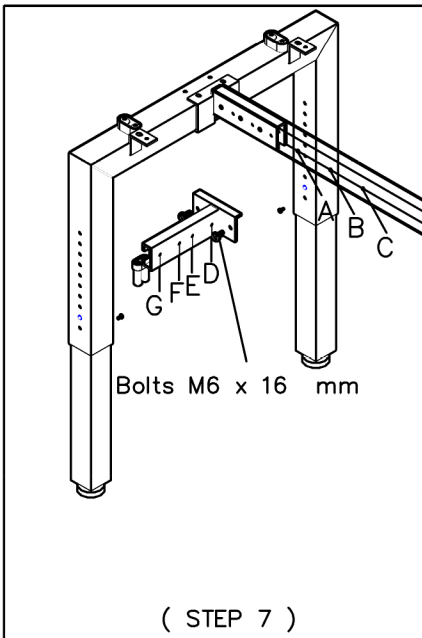

Bolts M6 x 16 mm

(STEP 7)

3

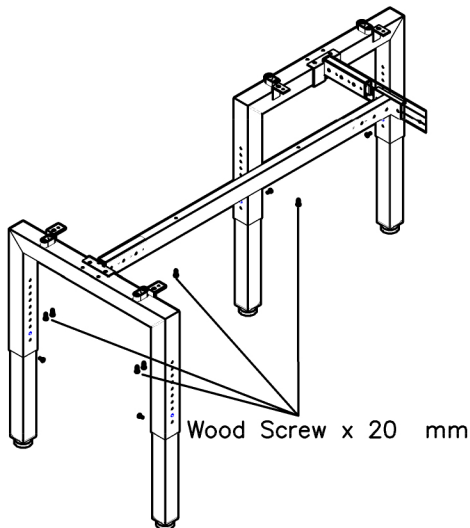

Wood Screw x 20 mm

(STEP 8 - 10)

PLTLEG - U - 24NB / 30NB

PART LIST
Main Desk Beam

1		Wood Screw x 20 mm	15pcs
2		Sticker	4pcs
3		Security Screw	8pcs

PART LIST
Return Beam

1		Wood Screw x 20 mm	6pcs
---	--	--------------------	------

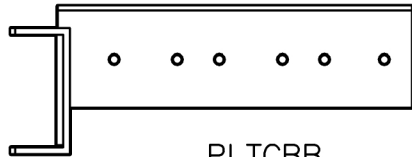

PLTCBB
Purchase Separately

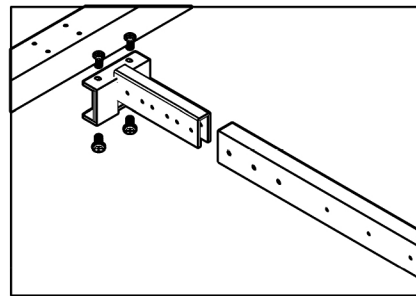

- Performance Work Surfaces Are Used In Many Applications. Preinstalled Existing Metal Inserts In The Top Are Not Required For The Element Series, 20 mm Wood Screw Are Provided .

DESK

1. Place work surface up side down on a clean surface.
2. Place both legs up side down on work surface with tabs PLTCBB facing each other .
3. Slide cross beam over both tabs on leg.
4. Attach cross beam to legs using M6 x 12mm (Part 3)
5. Attach center legs on the surface by using wood screw (Part 1).
Note : The wood screw pack is inside the beam.
6. Flip table over to correct position .

RETURN (IF USED)

7. Attach tab to desk cross beam using M6 x 12 mm bolts (Part 3).
* Use holes AB for 24" deep return.
* Use holes BC for 30" deep return.
8. Attach cross beam to return leg using M6 x 12 mm (Part 3) bolts.
9. Slide cross beam over tab that is attach to desk cross beam. attach using M6 x 12 mm bolts (Part 3)
10. Mount top on to return assembly using wood screw (Part 1).
Note : The wood screw pack is inside the return beam.

4. Possible Performance Element Series Configurations

When USING 24" Deep Main Top

1. Always use holes DE when main desk is 24" Deep.

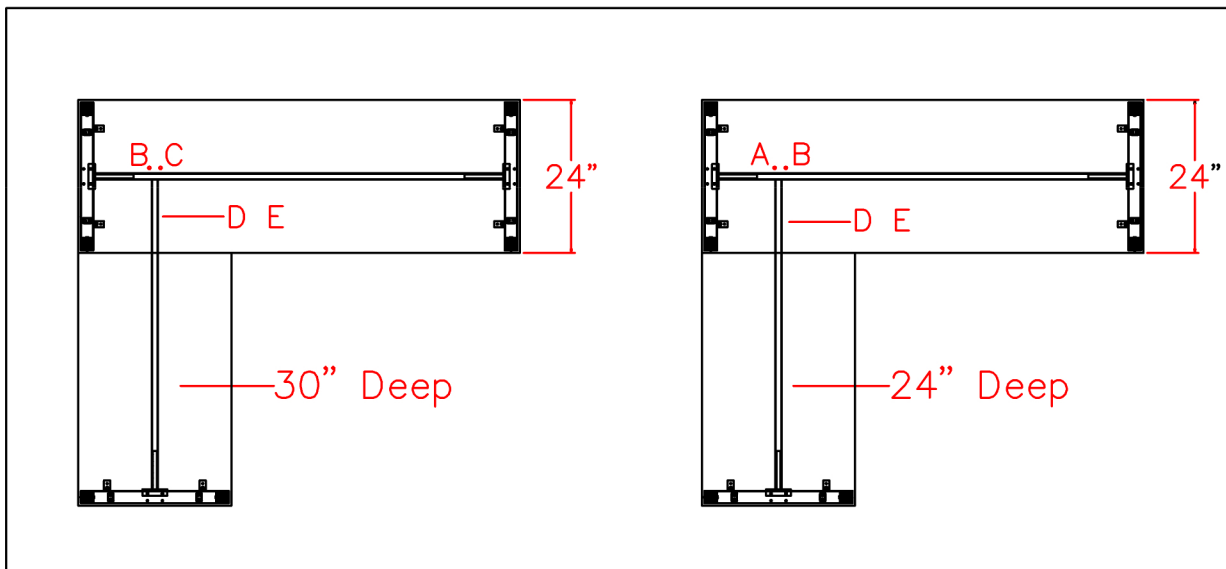

When USING 30" Deep Main Top

1. Always use holes FG when main desk is 30" Deep.

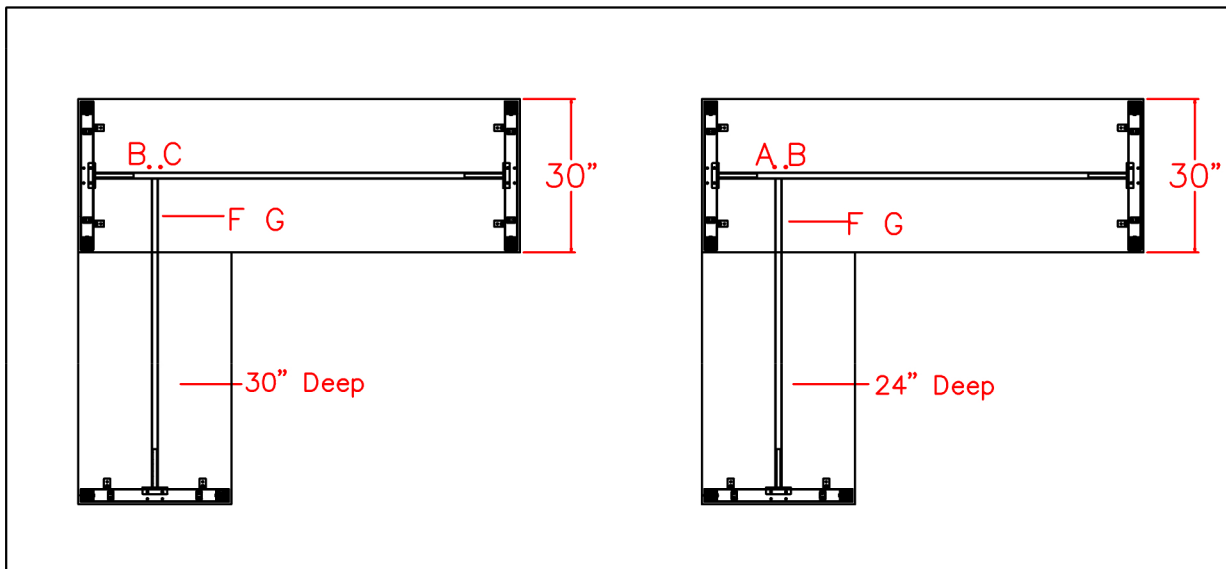

- # Always use holes AB when return is 24" Deep
- # Always use holes BC when return is 30" Deep

FOR GLIDES

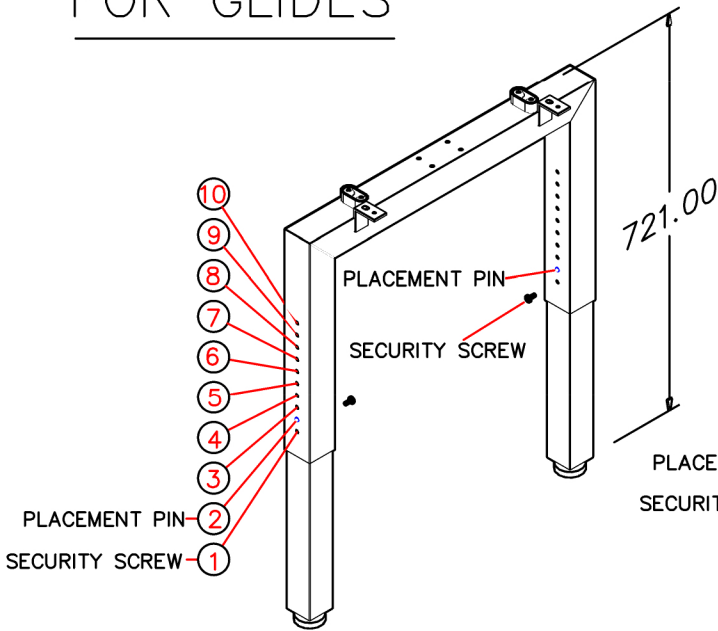

SECURITY SCREW AT HOLE NO. 1
PLACEMENT PIN AT HOLE NO. 2

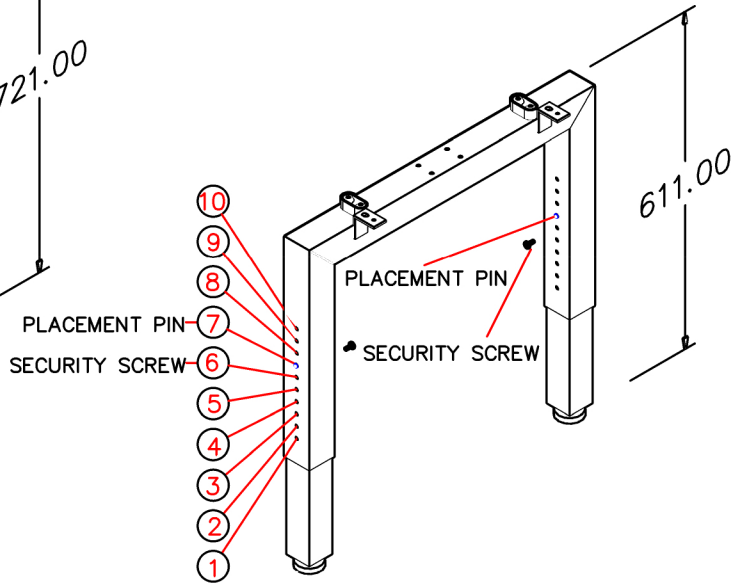

SECURITY SCREW AT HOLE NO. 6
PLACEMENT PIN AT HOLE NO. 7

FOR CASTERS

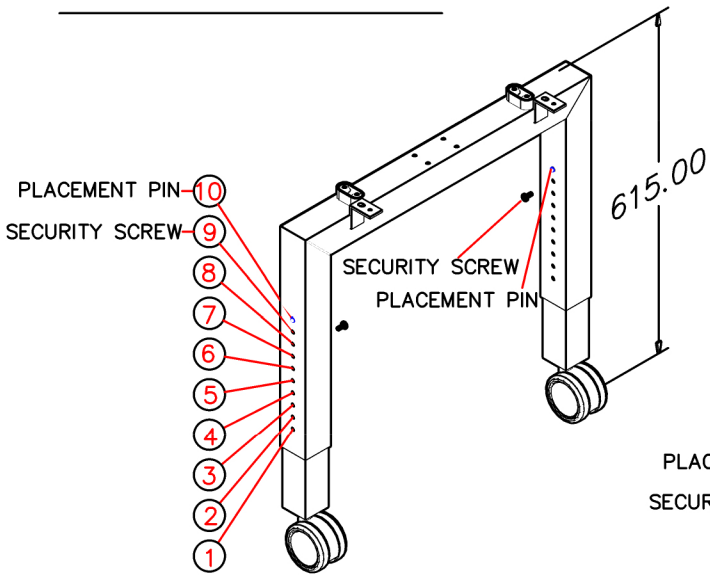

SECURITY SCREW AT HOLE NO. 9
PLACEMENT PIN AT HOLE NO. 10

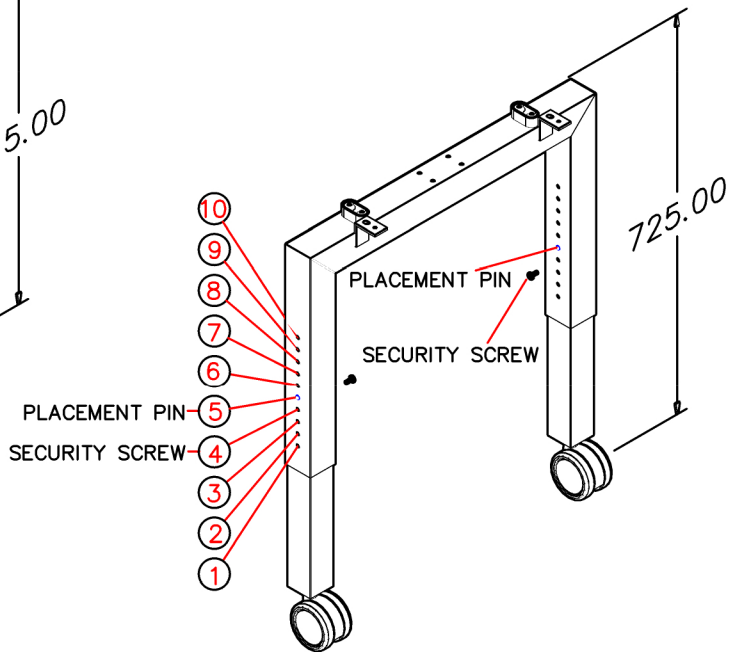

SECURITY SCREW AT HOLE NO. 4
PLACEMENT PIN AT HOLE NO. 5

- DO not tighten any screw or bolt until the unit is completely assembled.
- Ensure all bolts and screws are tightened before using the product, check bolts and screw every 6 months.
- If any parts are missing, broken, damaged or worn, stop use of products until repairs have been made using factory authorized parts.
- Failure to follow these warnings may result in injury.